

W329 DC-7 12/3/07

FM300S

DUST COLLECTOR

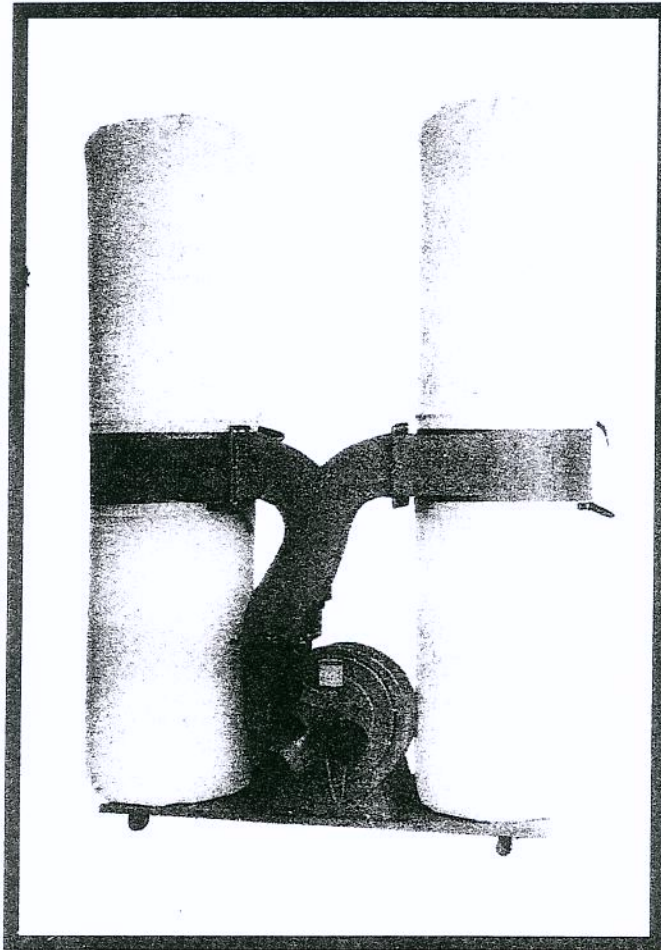

OWNER'S OPERATING MANUAL

15. Keep...

CONTENTS

SAFETY RULES	1
SPECIFIC SAFETY RULES	2
UNPACKING AND CHECKING CONTENTS	4
ASSEMBLY	5
MAINTENANCE	14
GROUNDING	15
PARTS DIAGRAM	16
PARTS LIST	17

TECHNICAL DATA

Motor power (HP/Watt)	3/2200
Inlet diameter (inch/mm)	4/100 × 3
Fan diameter (inch/mm)	12/305
Bag capacity (cubic meter)	0.3
Collection capacity (cubic meter/hr)	6000
Overall size (LWH) (MM)	1400 × 600 × 1960
Weight (kgs)	59

SAFETY RULES

- 1. READ AND BECOME FAMILIAR** with the entire operating manual.
- 2. KEEP GUARDS AND COVER** in place and in working order.
- 3. ALWAYS USE SAFETY GLASSES,** Also use face or dust mask if cutting operations is dusty. Everyday eye-glasses only have impact resistant lenses; they are not safety glasses.
- 4. KEEP WORK AREA CLEAN.** Cluttered areas and benches invite accidents.
- 5. DON'T FORCE TOOL.** It will do a better and safer job at the rate for which it was designed.
- 6. AVOID ACCIDENTAL STARTING.** Make sure switch is in "OFF" position before plugging in cord.
- 7. DISCONNECT TOOLS BEFORE SERVICING** and when changing accessories such as blades, bits, cutters.
- 8. DON'T OVERREACH.** Keep your proper footing and balance at all times. For best footing wear rubber soled footwear. Keep floor clear of oil, scrap wood, etc.
- 9. WEAR PROPER APPAREL.** Loose clothing or jewelry may get caught in moving parts. Wear protective hair covering to contain long hair.
- 10. MAKE WORKSHOP KIDPROOF.** Place a padlock on the switch when blade saw is not in use and store the key in a safe location.
- 11. REMOVE ADJUSTING KEYS AND WRENCHES.** Form habit of checking to see that keys and adjusting wrenches are removed from tool before turning it on.
- 12. AVOID DANGEROUS ENVIRONMENT.** Don't use power tools in damp or wet locations. Keep your work area well illuminated **DO NOT USE** in explosive atmosphere (around paint, flammable liquids, etc.)
- 13. KEEP CHILDREN AWAY.** All visitors should be kept a safe distance from work area, especially while operating unit.
- 14. USE THE PROPER TOOL.** Don't force tool or attachment to do a job for which it was not designed.
- 15. MAINTAIN TOOLS IN TOP CONDITION.** Keep tools sharp and clean for best and safest performance. Follow instructions for lubricating and changing accessories.
- 16. SECURE WORK.** Use clamps or a vise to hold work, when practical. It's safer than using your hand and prevents round or irregularly shaped pieces from turning.
- 17. CHECK DAMAGED PARTS.** Before further use of the tool, a guard or other part that is damaged should be checked to assure that it will operate properly and perform its intended function—check for alignment of moving parts, breakage of parts, mounting, any other conditions that may affect its operations. A guard or other part that is damaged should be properly repaired or replaced.
- 18. USE RECOMMENDED ACCESSORIES** — Consult Owner's Manual. Use of improper accessories could be hazardous.
- 19. NEVER STAND ON TOOL.** Injury could occur from a fall.
- 20. NEVER LEAVE TOOL RUNNING AND UNATTENDED.**
- 21. ALWAYS REMOVE CORD PLUG** from electrical outlet when adjusting, changing parts or working on tool.
- 22. This machine is 75 kgs.**
- 23. It can be machine transport.**
- 24. The machine assemble complete before try.**

SPECIFIC SAFETY RULES

When using your dust collection system follow basic precautions including the following:

WARNING: TO REDUCE THE RISK OF FIRE, ELECTRIC SHOCK, OR INJURY:

Read and understand this owner's manual and all labels on the Dust Collection System before operation. Use only as described in this manual. To avoid personal injury or damage to Dust Collection System, use only recommended accessories.

Sparks inside the electrical parts can ignite flammable vapours or dust. To avoid fire or explosion:

- Do not vacuum or use this dust collection system near flammable or combustible liquids, gases, gasoline or other fuels, lighter fluid, cleaners, oil based paints, natural gas, hydrogen, or explosive dusts like coal dust, magnesium dust, grain dust, or gun powder.
- Do not vacuum anything that is burning or smoking, such as cigarettes, matches or hot ashes.
- To avoid health hazards from vapours or dusts, do not vacuum toxic materials.
- Do not use or store near hazardous materials.
- Do not use outdoors or on wet surfaces.
- Put unit on a stable, level surface.
- Route vacuum hose and electric cord out of traffic areas.
- Do not allow to be used as a toy. Close attention is necessary when used around or near children.
- Do not leave appliance plugged in. Unplug from outlet when not in use and before servicing.
- To avoid injury from accidental starting, unplug power cord before changing or cleaning filter/dustbag or chip bag.
- Do not use without filter/dustbag and/or chip bag in place.
- Do not unplug by pulling on cord. To unplug, grasp the plug, not the cord.
- Turn off controls before unplugging.
- Do not use with damaged cord, plug or other parts. If your dust collection system is not working as it should, has missing parts, has been dropped, damaged, left outdoors, or dropped into water, return it to a Service Centre.
- Do not pull or carry by the cord, use cord as handle, close a door on the cord, or pull cord around sharp corners. Do not run dust collection system over cord. Keep cord away from heated areas such as direct sunlight.
- Do not handle plug of the dust collection system with wet hands.
- Do not put any object into ventilation openings. Do not vacuum with any ventilation openings blocked. Keep free of dust, lint, hair or anything that may reduce airflow.

- Keep hair, loose clothing, fingers, and all parts of the body away from opening and moving parts.
- Extension cords in poor condition or that are too small can pose fire and shock hazards. When using an extension cord, be sure it is in good condition.
- Connect to properly, grounded outlet only (see “grounding instructions” on page 13).

SAVE THESE INSTRUCTIONS

UNPACKING AND CHECKING CONTENTS

Unpack carton, check machine, to see parts listed below:

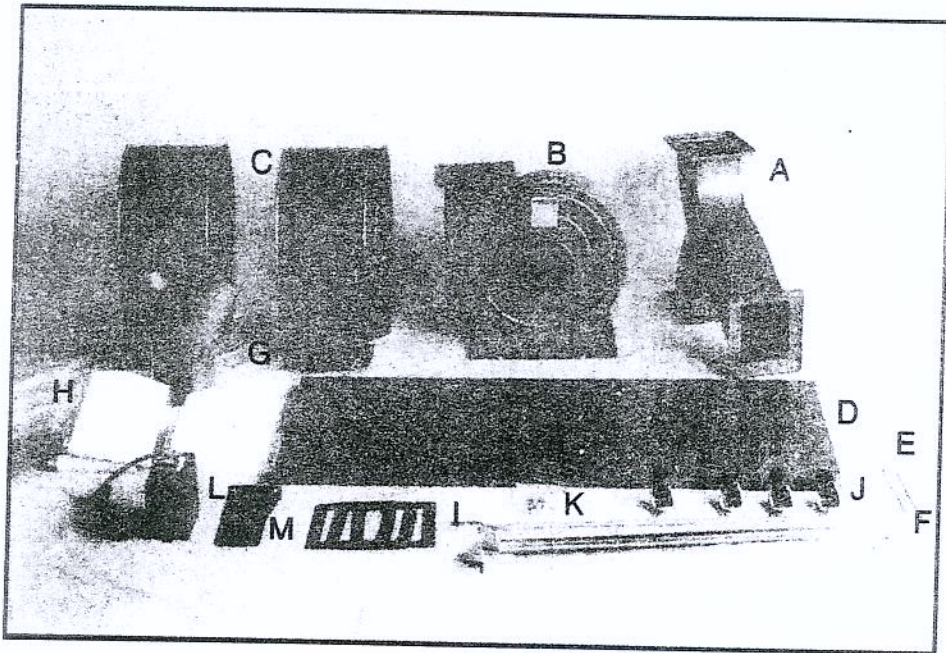

- A. CONNECTOR
- B. COLLECTOR BODY & FAN/MOTOR ASSEMBLY
- C. TWO COLLECTOR
- D. BASE PLATE
- E. TWO UPPER BAG SUPPORT
- F. TWO SUPPORT
- G. INLET
- H. FOUR BAGS
- I. THREE PACKING
- J. FOUR CASTERS
- K. NUTS, SCREWS, WASHERS, SPRING WASHERS, AND WRENCH
- L. SWITCH
- M. SWITCH PLATE

ASSEMBLY

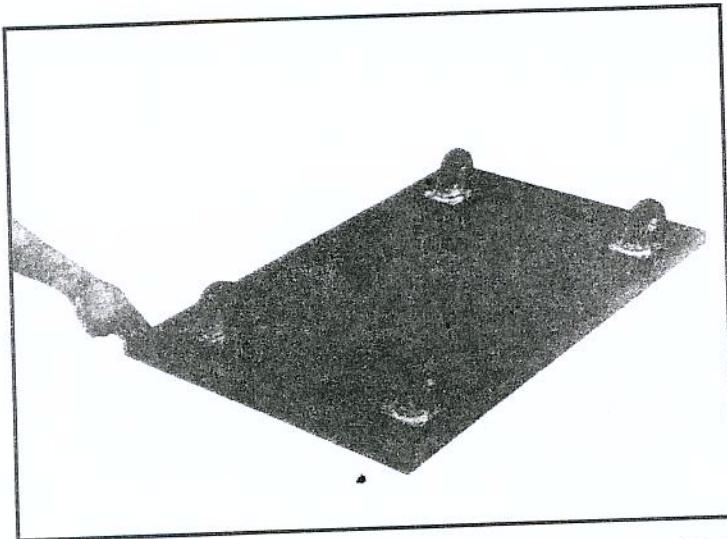

TO ASSEMBLE, FIRST PLACE THE BASE PLATE UPSIDE DOWN AND ATTACH THE FOUR CASTERS TO THE HOLES PROVIDED AND TIGHTEN WITH THE WRENCH. FIG. 1.

FIG. 1.

THE COLLECTOR BODY COVER LOOSE THE SCREW WITH THE WRENCH AS SHOWN IN FIG 2.

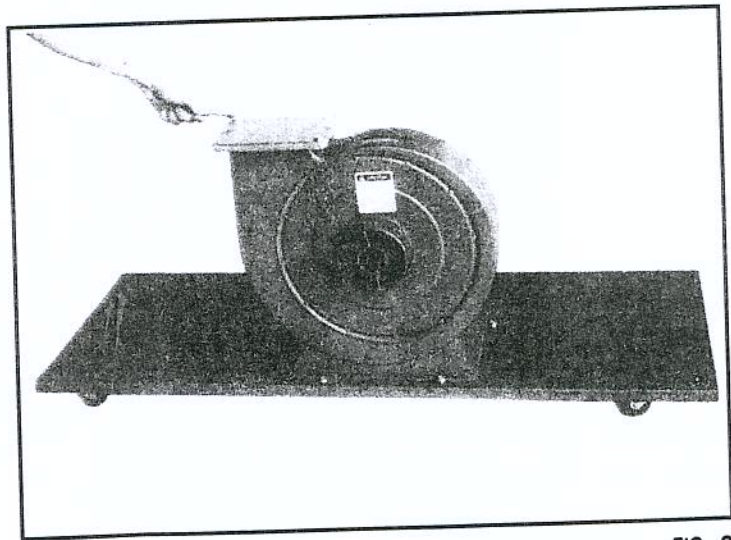

FIG. 2.

WITH THE COLLECTOR BODY
& FAN/MOTOR ASSY IN
PLACE, SECURE IT TO THE
BASE PLATE USING THE
SCREWS AND WASHERS PRO-
VIDED AS SHOWN IN FIG. 3.

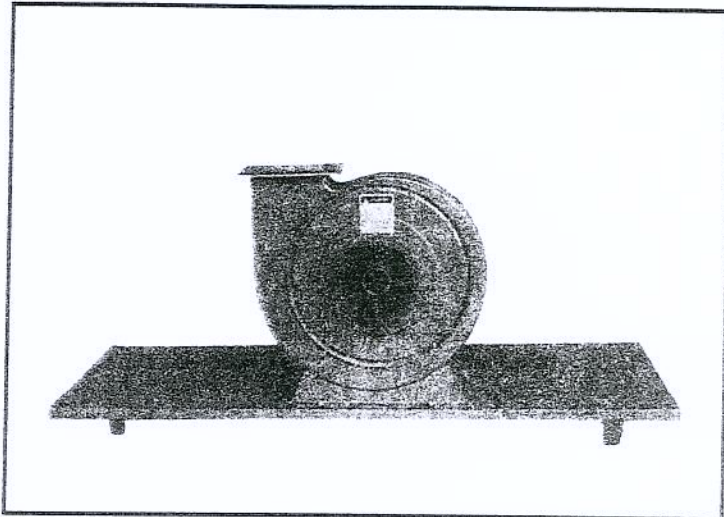

FIG. 3.

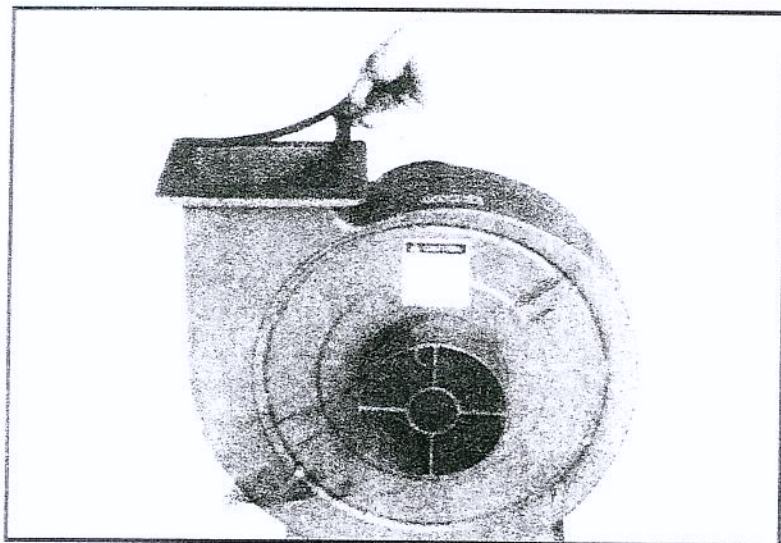

FIG. 4.

INSTALL THE PACKING AND CONNec-
TOR TO THE COLLECTOR BODY ASSY
USING EIGHT SCREWS AND WASHERS
PROVIDED. FIG. 4. AND FIG. 5.

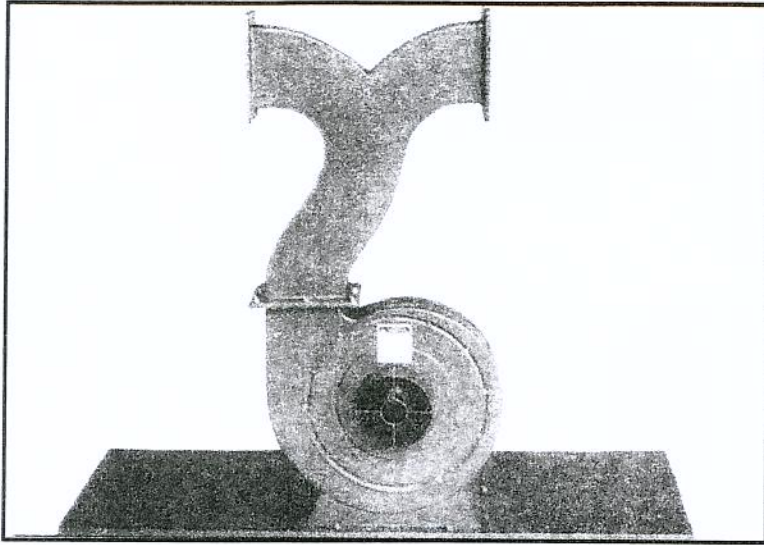
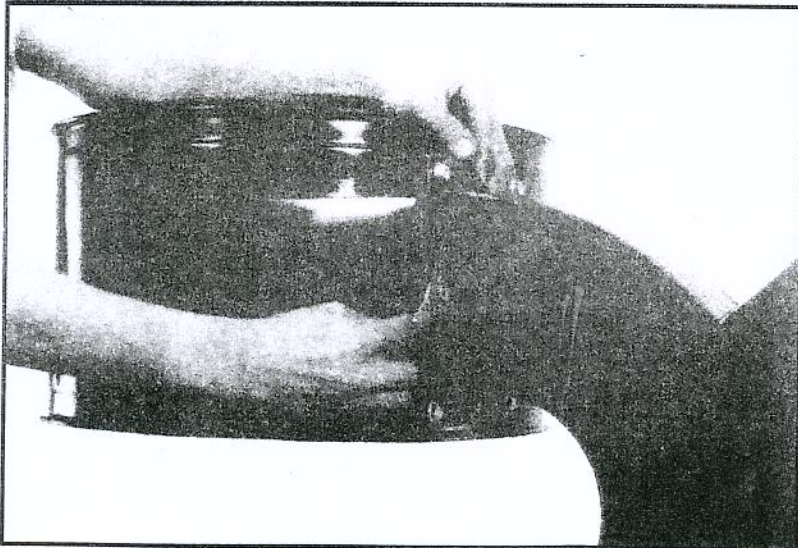

FIG. 5.



NEXT INSTALL THE
TWO COLLECTORS (C)
TWO PACKING (I) TO
THE OUTLET AS
SHOWN IN FIG. 6.

FIG. 6.

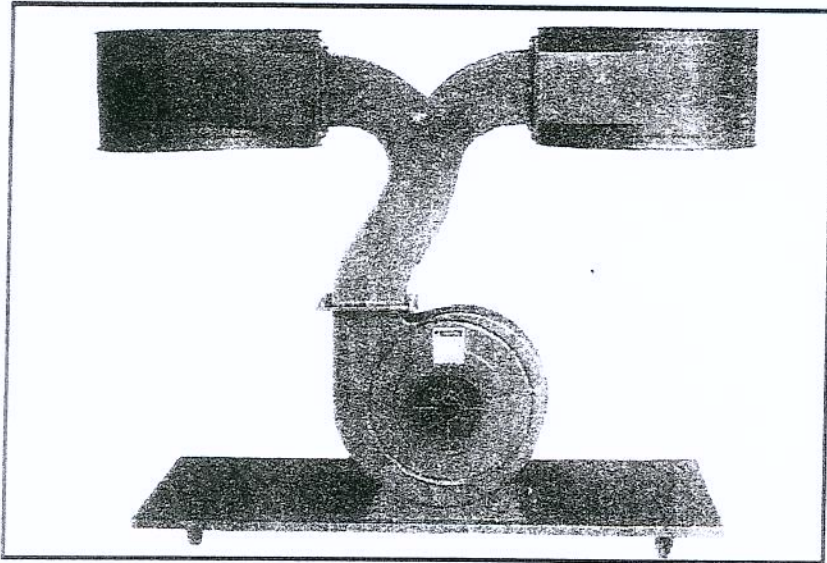

FIG. 7. SHOWS THE TWO COLLECTORS ATTACHED TO THE OUTLET AND FAN/MOTOR ASSY.

FIG. 7.

NOW INSTALL THE TWO COLLECTOR SUPPORTS (F) AS SHOWN IN FIG. 8. AND FIG. 9.

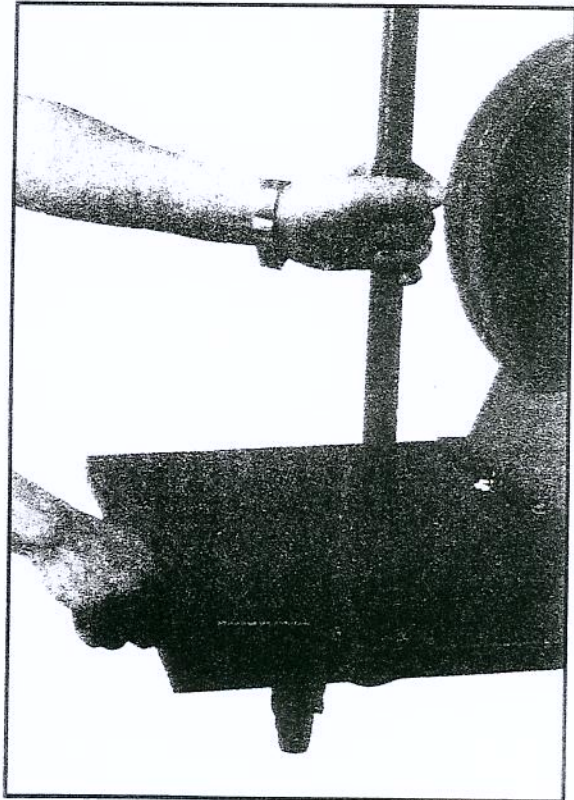

FIG. 8.

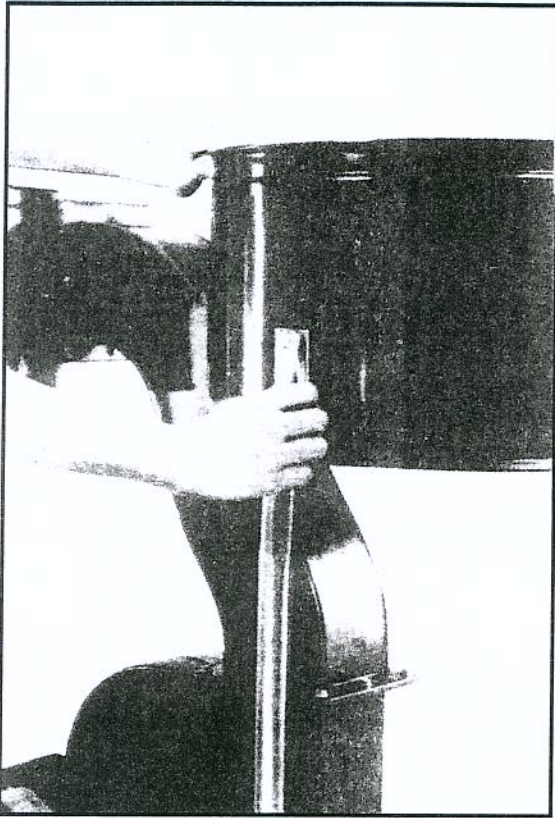

FIG. 9.

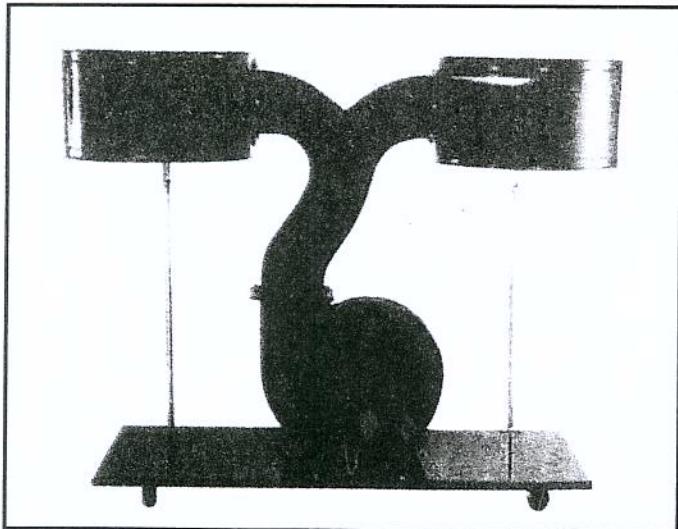
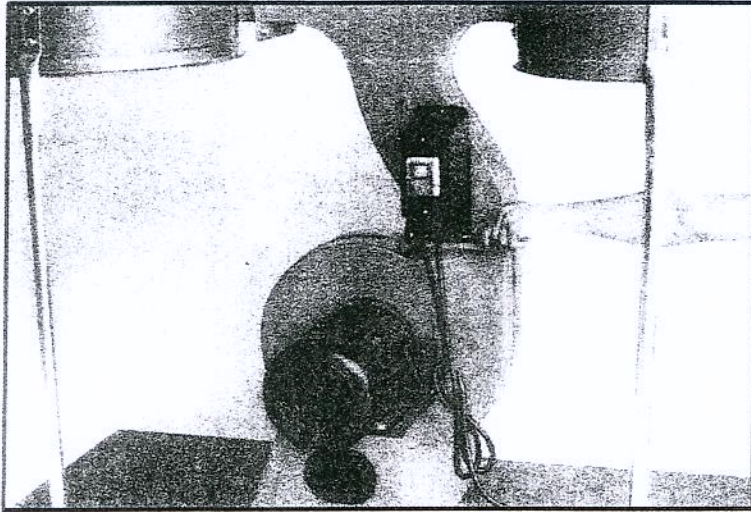

FIG.10. SHOWN THE DUST COLLECTOR AS IT SHOULD NOW APPEAR.

FIG. 10.



THE SWITCH FIXED TO THE
COLLECTOR BODY WITH
WRENCH AS SHOWN IN FIG. 11

FIG. 11.

AT THE TIME THE UPPER BAG
SUPPORT SHOULD BE INSTALLED
ONTO THE COLLECTOR SUPPORT
AS SHOWN IN FIG. 12.

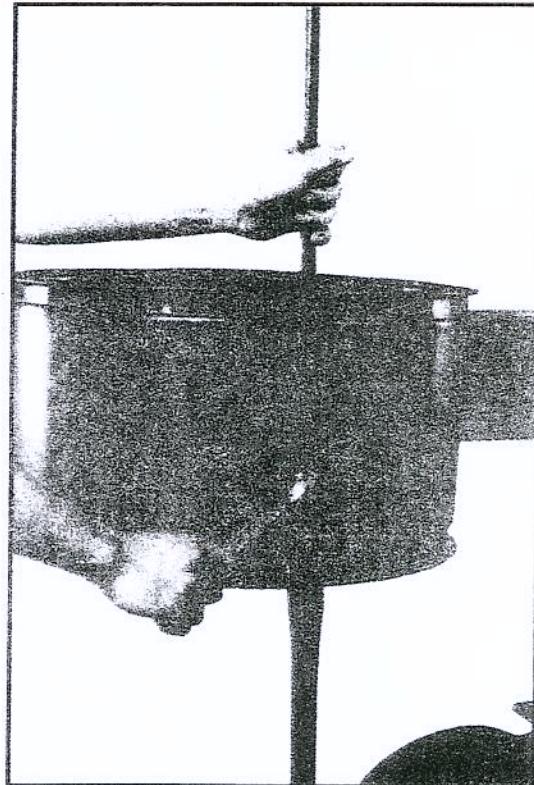

FIG. 12.

NEXT, HANG THE TWO BAGS (H) FROM THE SUPPORT RODS AS SHOWN IN FIG. 13.

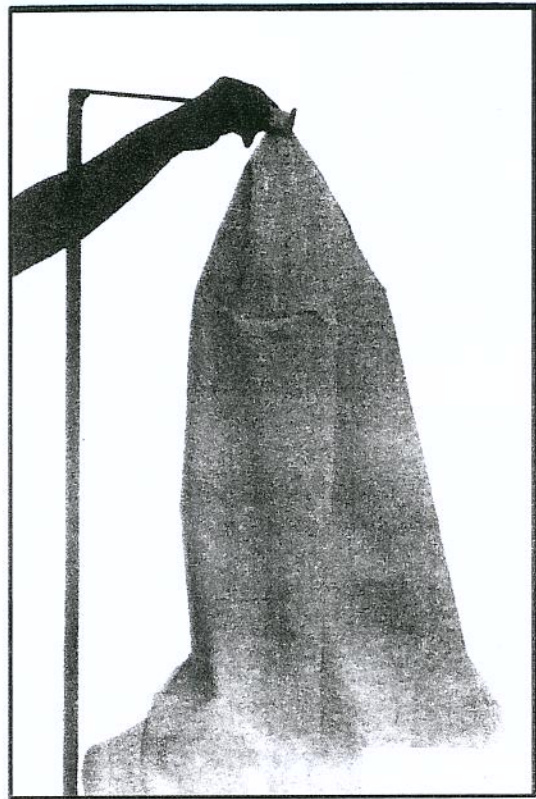

FIG. 13.

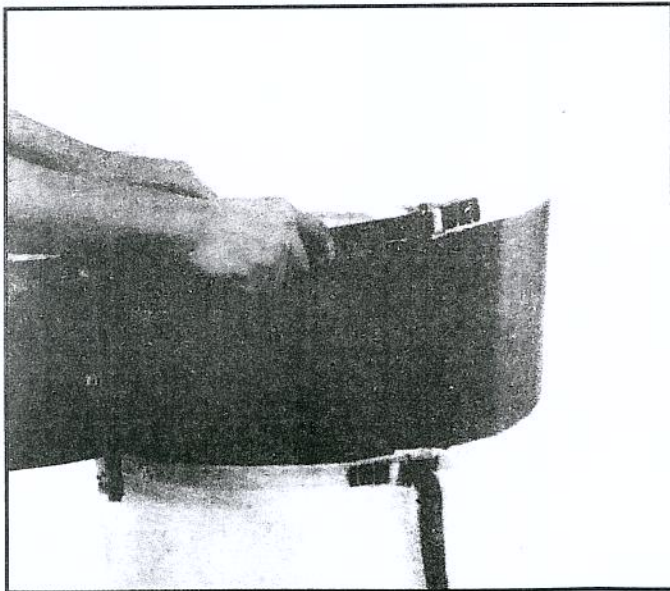

FIG. 14.

NOW ATTACH THE TWO FILTER AND TWO COLLECTION BAGS TO THE COLLECTORS USING THE BANDS SEWN IN THE BASE OF THE BAGS AS SHOWN IN FIG. 14.



FIG. 15.

THE SHUTTER CAN NOW BE PLACED ON THE INTAKE HOLE OF THE FAN/MOTOR ASSY AS SHOWN IN FIG. 15.

YOUR NEW DUST COLLECTOR SHOULD NOW LOOK LIKE THE ONE PICTURED IN FIG. 16.

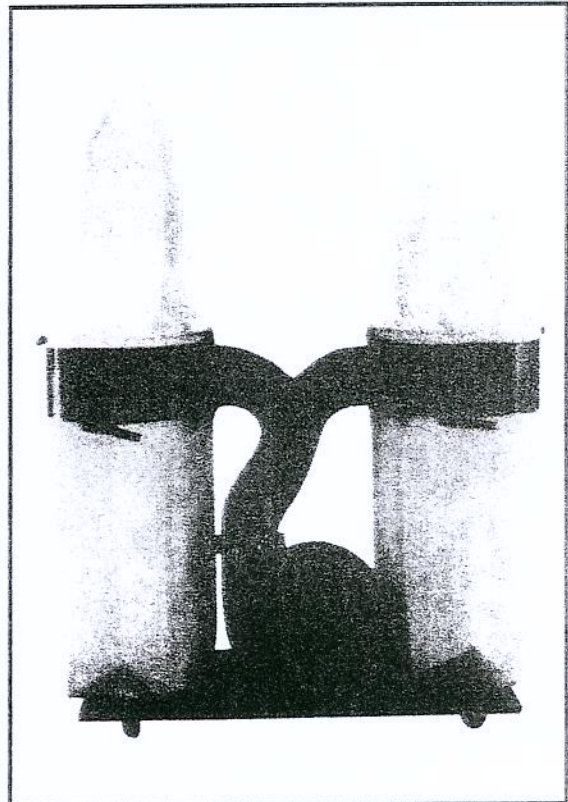
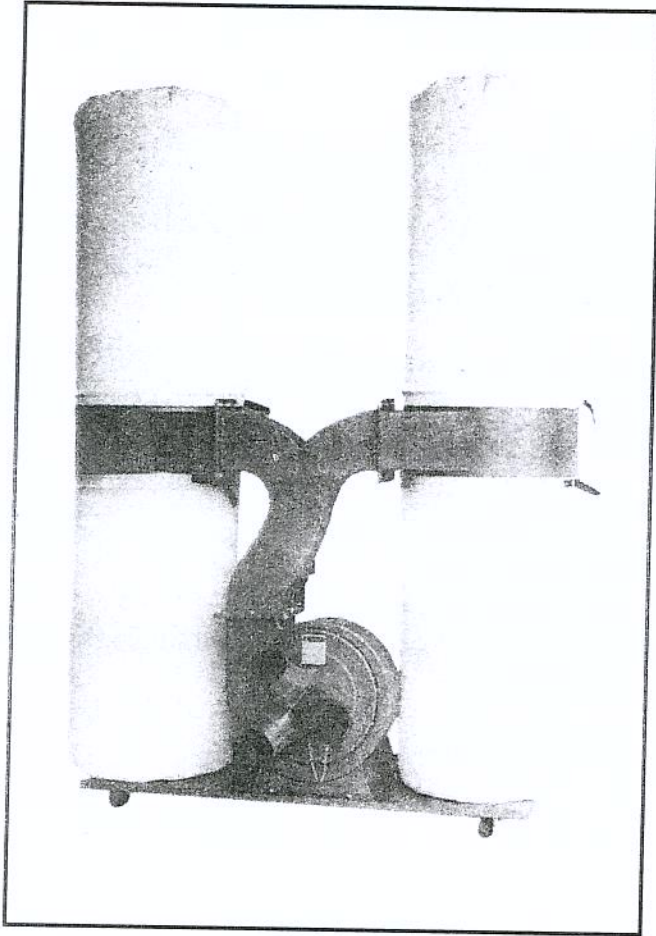

FIG. 15



THE DUST COLLECTOR IS NOW READY TO BE PLACED INTO SERVICE. BEFORE CONNECTING TO A POWER SOURCE, BE SURE THE POWER SOURCE IS PROPERLY GROUNDED AND IS OF PROPER VOLTAGE AND AMPERAGE.

OPTIONAL ACCESSORIES :

Part No.	DESCRIPTION	Part No.	DESCRIPTION
00-0101	9" ALUMINUM FAM	00-0304	FLEXIBLE HOSE, 6" IN DIA.
00-0102	12" ALUMINUM FAM	00-0401	REDUCER, 4" TO 2"
00-0201	BAG CLAMP FOR CT-80 A/C	00-0501	HOSE CLAMP, 2" OR 6"
00-0202	BAG CLAMP FOR CT-90 A/C	00-0601	TRANSPARENT COLLECTING BAG
00-0203	BAG CLAMP FOR CT-99 HA/HC	00-0701	AIR FLOW CONTROL GATE, 4" IN DIA.
00-0204	BAG CLAMP FOR CT-101/101H/201/201H	00-0801	TAPERED CONNECTOR, 4" IN DIA.
00-0205	BAG CLAMP FOR CT-202	00-0901	2-HOLE MANIFOLD, 4" OUTLET/5" INLFT
00-0206	BAG CLAMP FOR CT-401	00-0902	3-HOLE MANIFOLD, 4" OUTLET/6" INLFT
00-0301	FLEXIBLE HOSE, 2" IN DIA.	00-0903	4-HOLE MANIFOLD, 4" OUTLET/6" INLFT
00-0302	FLEXIBLE HOSE, 4" IN DIA.	00-0904	5-HOLE MANIFOLD, 4" OUTLET/9" INLFT
00-0303	FLEXIBLE HOSE, 5" IN DIA.		

MAINTENANCE

MOTOR

Excessive dust in the motor could cause overheating. Every effort should be made to prevent foreign material from entering the motor. When operated under conditions likely to permit accumulations of dust, dirt, or waste within the motor, a visual inspection should be made at frequent intervals. Accumulations of dry dust can usually be blown out. Use a low-pressure air hose.

NOTE: Motors used on woodworking tools are particularly susceptible to the accumulation of sawdust and wood chips and should be blown out or vacuumed frequently to prevent interference with normal motor ventilation.

CAUTION: To avoid eye injury or adverse reaction to dust, high air pressure should not be used especially in poorly ventilated areas, the operator performing this task should wear safety goggles and a mask.

Do not use unit if the power cord becomes worn or frayed.

If any servicing (other than the above cleaning) becomes necessary, it should be performed by an authorized Service center.

NOTE: The speed of this motor cannot be regulated or changed.

GROUNDING

1. In the event of a malfunction or breakdown, grounding provides a path of least resistance for electric current to reduce the risk of electric shock. This tool is equipped with an electric cord having an equipment-grounding conductor and a grounding plug. The plug must be plugged into a matching outlet that is properly installed and grounded in accordance with all local codes and ordinances.
2. Do not modify the plug provided it will not fit the outlet, have the proper outlet installed by a qualified electrician.
3. Improper connection of the equipment grounding conductor can result in a risk of electric shock. The conductor with insulation having an outer surface that is green with or without yellow stripe is the equipment grounding conductor. If repair or replacement of the electric cord or plug is necessary, do not connect the equipment-grounding conductor to a live terminal.
4. Check with a qualified electrician or serviceman if the grounding instructions are not completely understood, or if in doubt as to whether the tool is properly grounded.
5. Use only 3-wire extension cords that have 3-prong grounding plugs and 3-pole receptacles that accept the tool's plug.
6. Repair or replace damaged or worm core immediately.
7. This tool is intended for use on a circuit that has an outlet that looks like the one illustrated in sketch A. The tool has a grounding plug that looks like the plug illustrated in sketch A. A temporary adapter, which looks like the adapter illustrated in sketches B and C, may be used to connect his plug to a 1-pole receptable as shown in sketch B if a properly grounded outlet is not available. The temporary adapter should be used only until a properly grounded outlet can be installed by a qualified electrician. The green-colored rigid ear, lug, etc. extending from the adapter must be connected to a permanent ground such as a properly grounded outlet box.

NOTE: The type of electrical plug and receptacle differs from country to country.
Caution: In Canada only the grounding shown in figure (A) is acceptable. The extension cords should be CSA certified S.J.T. type or something better.
Caution: In Australia only the grounding shown in figure (D) is acceptable. The extension cords should be SAA certified.

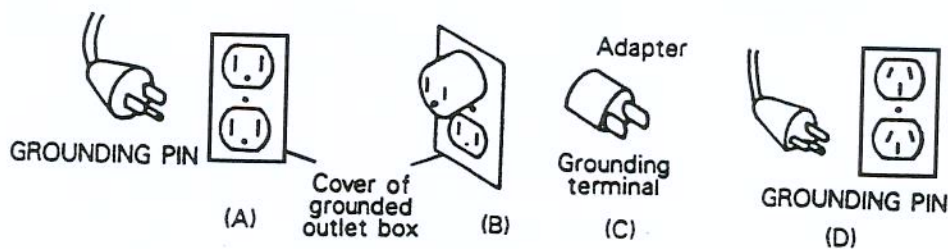

PARTS DIAGRAM

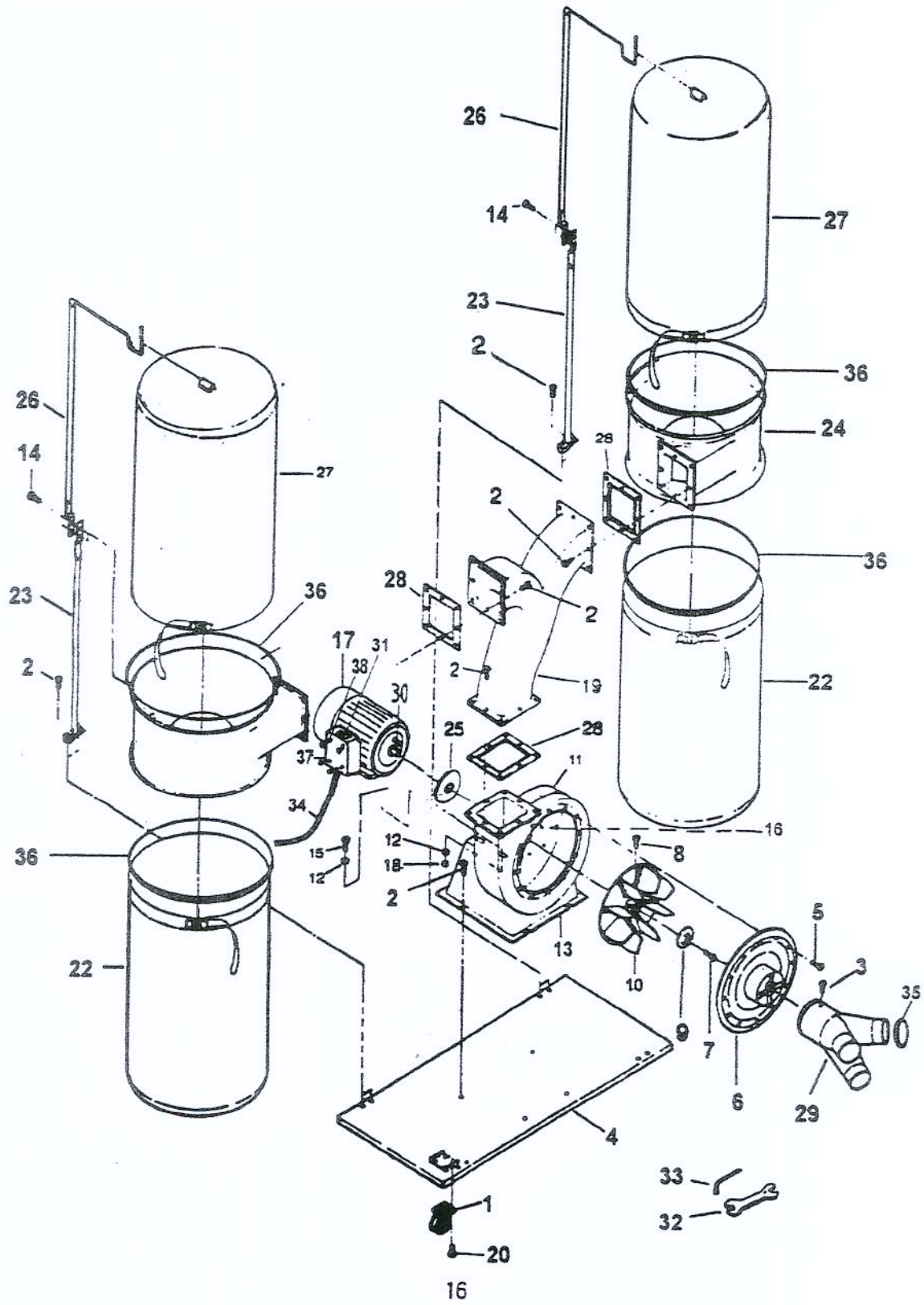

PARTS LIST

No.	DESCRIPTION
1	Caster
2	Screw Hex. Fig. Hd.
3	Screw
4	Base plate
5	Screw Pan. Fig. Hd.
6	Inlet cover
7	Screw Hex. Soc. Hd.
8	Screw Hex. Hd.
9	Washer
10	Turbo fan
11	Collector body
12	Washer
13	Motor support
14	Screw Hex. Fig. Hd.
15	Screw Hex. Hd.
16	Bolt
17	Motor
18	Nut
19	Outlet
20	Screw
21	Left-collector
22	Collector bag
23	Collector support
24	Right collector
25	Packing
26	Upper bag support
27	Filter bag
28	Packing
29	Inlet
30	Key
31	Switch
32	Open end wrench
33	Wrench Hex.
34	Cable
35	Cap
36	Bag clamp
37	Switch box
38	Round head screw